

# Instruction Manual for Ionizer

Thank you very much for your purchase of the optional ionizer.  
Please read this manual and fully understand it before using the device. If you have any question, contact your local distributor.

## Before using

Before using this device, be sure to read the cautionary and safety information in the operation manual, as well as each of the items below.

- Hint!**
- It is possible that enough effect cannot be achieved depending on your using environment or the media.
  - It is recommended to check the effect of removing electricity in advance.

### Warning and Note

- Caution!**
- High voltage is applied. Prevent it from water, oil, flammable solvent, etc. being poured. Otherwise, breakdown occurs or it may cause an electric shock and failure of the machine.
  - Do not put metals, your body, your finger, etc. closer to it. It may cause an electric shock and failure of the machine.
  - There is a danger that generated ozone may do something detrimental to you if the machine is used in the close place. When you use the machine in the close place, be sure to ventilate.
  - Do not use in a place where the temperature changes significantly or dew condensation occurs.
  - Before maintaining or taking care of it, be sure to turn off the main power of the main body.
  - When taking care of it, do not touch the electrode probe directly.
  - Should an abnormality is found, contact a distributor in your district or our office. Do not repair the machine by the customer. It may cause an electric shock and failure of the machine.
- Warning!**
- Do not touch the electrode probe with a hard thing such as a tool. It may cause an accident or failure of the machine.
  - Due to prolonged use, dust/ink adhere to the electrode probe and it becomes dirty. If you keep using it as it is, the machine cannot produce the performance to remove electricity enough, and it may cause an accident or failure of the machine. Be sure to take care of it.
  - Do not use this for any purpose other than eliminating static electricity.

## Setting the ionizer

Before using the optional ionizer, you must set the ionizer setting to "ON" on the printer.

- Press [FUNC1] (MENU) ⇨ [ENTER] key in LOCAL, and select "Setup".
- Press [▲][▼] to select SETUP 1 to 4, and press the [ENTER] key.
- Press [▲][▼] to select "Ionizer", and press the [ENTER] key.
- Press [▲][▼] to select "ON", and press the [ENTER] key.
  - The ionizer setting is now set to "Enabled".
  - Press the [END] key several times to end the setting.

## How to use

When you use the optional ionizer, the function to remove electricity operates during printing to help avoid media sticking.

### When setting media

When setting media, refer to the operation manual that came with your printer.

- Caution!**
- Be careful not to touch the electrode probe when setting media. If you do not do printing, the electrode probe will not be energized, but there is a danger of injury as the tip is sharp.

### At normal printing

After setting the media, make the machine "REMOTE" status and print from RasterLink.  
The function to remove electricity operates and it prints the media while removing electricity of it.

- Hint!**
- If removing electricity is not necessary, set the ionizer setting to "OFF" in step 4 of "Setting the ionizer".

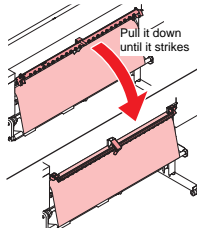

## Daily care

Check the electrode probe before the work and clean it if it is dirty.



- Before taking care of it, be sure to turn off the main power switch of the main body. You may get an electric shock. Also, you may get injured collaterally.
- Do not touch the electrode probe directly. You may get injured. Be careful to work.

### 1 Remove the electrode probe from the ionizer.

- By using the attached electrode probe replacement kit, you can remove it easily.



### 2 Wipe off the electrode probe and around it with a cotton swab immersed in alcohol.

- Recommended: ethyl alcohol, isopropyl alcohol

**Hint!**

- When it is very dirty, use an ultrasonic bath. Also, you can use alcohol as washing liquid.



**Important!**

- After cleaning, fully dry it and then attach it to the ionizer to use. When washing liquid remains on the electrode probe, it may cause an accident or failure of the machine.

## Alarm output function

This ionizer has the function to output alarms.

### Alarm output part

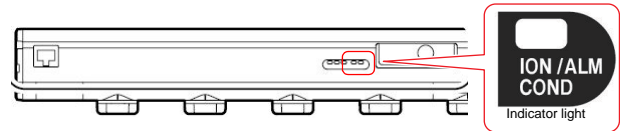

### Alarm function

Item	Alarm (ALM)	Ion level (ION)	Condition (COND)
Printer error message	ERROR 525 WRONG IONIZER	ERROR 526 IONIZER ION LEVEL	ERROR 527 IONIZER CONDITION
ION / ALM / COND	Indicator light blinks three times about every second.	Indicator light blinks twice about every second.	Indicator light blinks. once about every second
Status etc.	Internal circuit has been broken. Abnormal discharge occurs.	Due to blot on the electrode probe and wear of it, ion production has decreased. Use this as a guide for time to take care of the electrode probe.	The installed environment (temperature, humidity, peripheral metals, etc.) have affected the performance to remove electricity.
Removing electricity	Removing electricity stops.	Removing electricity continues.	Removing electricity continues.
Countermeasure	Contact a distributor in your district or our office.	Take care of the electrode probe. <sup>*)</sup> If the status cannot be improved, replace the relevant electrode probe.	Check the environment and peripheral metals.
Replacement part	—————	SPA-0208 Tungsten electrode probes for ionizer (including 4)	—————

\*1. Before taking care of the electrode probe, turn off the main power of the main body, and be careful to perform the work.